

TECHNICAL SPECIFICATION SHEET

RS-360 Wireless Plumbing Leak Protection System

BUTTERFLY VALVE SIZES: 2-1/2", 3", 4"



Actual models may vary.

- Disables the water supply to your home or facility when a plumbing leak or low temperature is detected.
- Activates an audible alarm and sends a signal to home security system.
- Unit must be manually reset by user before the system will allow water to flow again.
- Butterfly valve; suitable for potable water.
- On-board battery backup for 24/7 protection against water damage.
- Full range of accessories available to tailor the system to meet any application.

RS-360 Component Dimensions

Model #	Description	Receiver (L x W x H)	Sensor (Dia. x H)	Wall Plug (Length)	Sensor Range
RS-360	Wireless Total Water Main Shut-Off	8.25" x 5" x 3"	4.25" x 1.25"	6'	100'

Butterfly Valve Body

	PART NAME	MATERIAL	# PCS.
1	Body	Ductile Iron	1
2	Seat	EPDM (-30° to 250°F)	1
3	Lower Shaft	SS 416	1
4	DISC 500N	Iron Nylon 11	1
	DISC 500S	Stainless Steel	
5	Upper Shaft	SS 416	1
6	Locating Pin	Carbon Steel	1
7	Bushing	PTFE	1
8	O-Ring	EPDM	1
9	Lever	Epoxy-Coated Carbon Steel	1



Manually operated butterfly valves.

- Epoxy-coated ductile iron lug body
- Full-port sizes: 2-1/2", 3", 4"
- EPDM-resilient seat: -30°F to 250°F
- API609 face-to-face flange
- Floating dual-shaft disc design
- 10-position stop
- MSS SP 67 compliant
- No pins in disc – eliminates potential

Nylon 11 Coated Disc
CF8M SS Disc



Valve Dimensions:

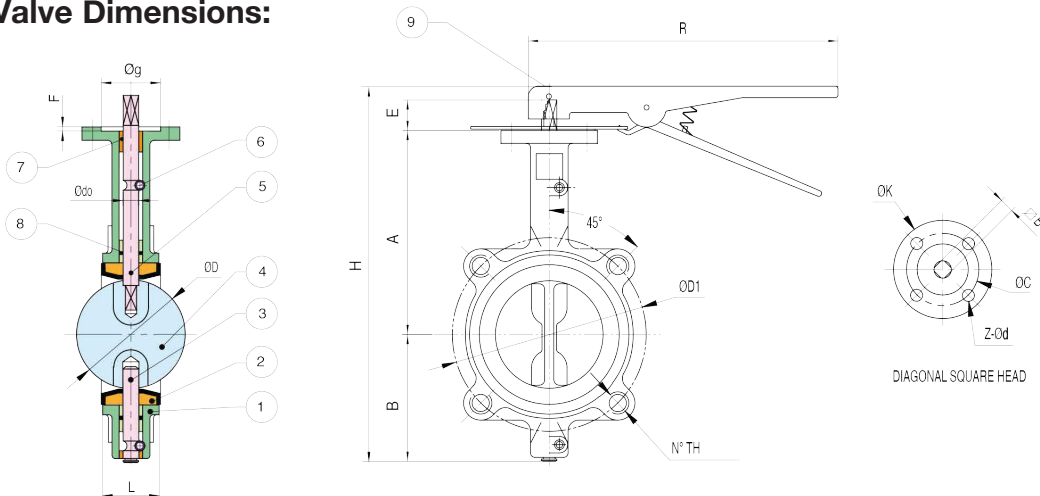

Note: Butterfly valves require appropriate mounting flange and hardware (not included). Please see install manual for details.

*Recommended flange: 316/316L SS
forged, threaded NPT-F, 150 lb. ANSI
raised-face flange (raised surface on
the back).*

Size	ØC ISO	∠B	A	B	L	ØD	E	H	R	Ødo	Upper Flange				DISC	LUG	WT.	Seat Torque		CV (GPM @ 1 psi)	
											ØK	Z-d	Øg	F	ØD1	N°-TH	Lbs.	100 psi	200 psi	50% OP	100% OP
2-1/2"	F05	9mm	6.89	3.50	1.76	2.54	0.47	15.04	10.63	0.50	3.03	4-0.28	1.38	0.12	5.49	4-5/8"-11	9.3	134	167	65	220
3"	F05	9mm	7.13	3.74	1.78	3.10	0.47	15.51	10.63	0.50	3.03	4-0.28	1.38	0.12	6.00	4-5/8"-11	10.4	205	223	70	300
4"	F07	11mm	7.87	4.49	2.05	4.09	0.63	17.00	10.63	0.62	3.54	4-0.35	2.17	0.12	7.50	8-5/8"-11	19.8	339	386	140	605

MA Board of Registration of Plumbers Approval from 05/06/2015 – 05/06/2018 Code # P1-0515-489.

Electric Actuator

- Housing made from a V0 self-extinguish class techno-polymer material.
- Direct connection of actuator to valves is made via a painted die-cast aluminum plate with a dual-drilled ISO 5211 interface.
- Electronic circuit automatically adjusts the motor speed (depending on torque variations) to keep cycle time constant.
- Electronic system and torque limiter are standard.
- Standard heater is activated once actuator is powered and when the temperature inside the housing drops below 77°F to prevent condensation.



Electric Actuator Specifications:

- | | | | |
|------------------------------|-------------------------------------|--------------------------|---------------|
| • Max. Working Torque: | 266 in.-lbs. | • Manual Intervention: | STD |
| • Voltage (V) – Low Voltage: | 12 VAC | • Position Indicator: | STD |
| • Working Time: | 8 seconds | • Working Temperature: | -4°F to 131°F |
| • Torque Limiter: | STD | • Heater: | STD |
| • Duty Rating: | 75% | • Drilling ISO 5211 Pad: | F03 - F05 |
| • Protection: | IP65-67* NEMA 4X | • Square Inch: | 0.43 |
| • Rotation: | 90°
180° or 270°
upon request | • Weight: | 5.07 lbs. |

* UL pending

Electric Actuator Power Consumption:

- Nominal Voltage: 12 VAC
- Absorbed Current: 2.0 A
- Absorbed Power: 24 VA
- Frequency: 50/60 Hz

Actuator Dimensions:

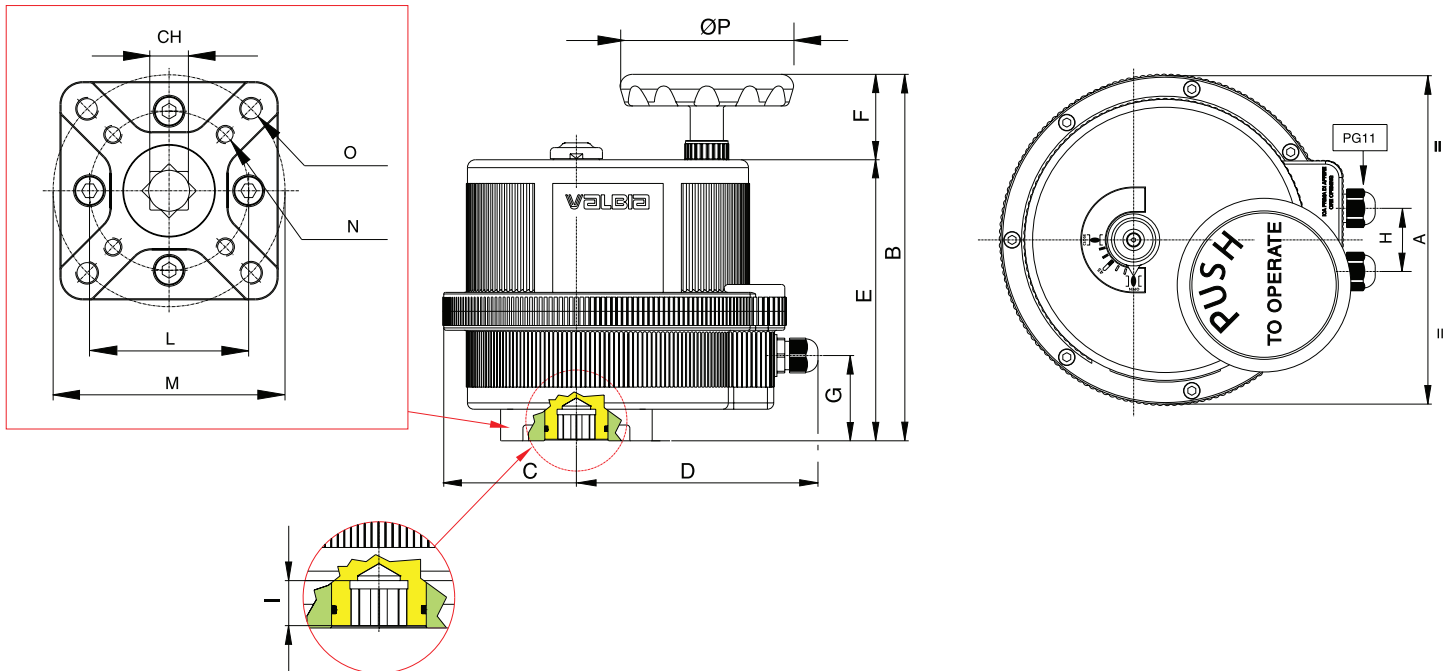

Model	DRILLING ISO 5211	CH	A	B	C	D	E	F	G	H	I	L	M	N	O	ØP
VB030	F03-F05*	0.43	6.18	7.40	2.38	5.12	5.75	1.65	1.30	1.42	0.47	1.42	1.97	10-24 UNC 2BX0.47	1/4-20 UNC 2BX0.55	2.56

* Upon request F04 only

MA Board of Registration of Plumbers Approval from 05/06/2015 – 05/06/2018 Code # P1-0515-489.