



TECHNICAL SUBMITTAL DATA SHEET

Plenum-Rated Water Leak Detection / HVAC & AC Condensate Pan Overflow Alarm

Job Name: _____	Job Location: _____
Engineer: _____	Engineer Approval: _____
Contractor: _____	Contractor Approval: _____
Contractor P.O.: _____	Representative: _____

MODEL RS-096-MK6

TYPICAL INSTALLATIONS INCLUDE:

- Simple water leak detection in a plenum space, including plenum HVAC/water chiller condensate pans for overflow detection

HIGHLY RECOMMENDED FOR:

- Commercial office buildings
- Multi-residential complexes
- Above/near data processing rooms
- Medical facilities and labs
- Facilities with a history of insurance claims for water damage

FEATURES:

- Plenum-rated wires for the water sensor and power supply
- Step-down transformer (120, 208, 240V AC to 24V AC) with mounting plate in lieu of standard wall wart
- Reusable and testable; easy reset button
- Adjustable sensor height and orientation
- Dry contacts (NO/C/NC) to tie into existing building automation and security systems
- Audible alarm (83 dB)
- Pre-wired with basic connections to the power transformer and the sensor



APPLICATION CONSIDERATIONS:

Local fire, safety and electrical codes have strict guidelines for installation of electrical devices in plenum spaces, typically requiring that all devices be hard-wired directly to their power source and that special-grade "plenum-rated" wires be used. These special requirements often require a field retrofit to code, resulting in added time and expense. RDT makes it easy and convenient to work within these challenging spaces with its plenum-rated FloodMaster MK6 series kits.

The RS-096-MK6 system is designed to detect and notify you of leaks from water-fed appliances, pipes, plumbing fixtures, and tanks/containers located in a plenum space. It can also be used to prevent water damage caused by overflowing air conditioning, HVAC, HAVCR and water chiller condensate pans.

INSTALLATION OVERVIEW:

The system is hard-wired through a step-down transformer (120, 208, 240V AC to 24V AC). The water sensor is placed in an area where water is likely to accumulate, either horizontally or vertically. Install the sensor flush to the floor for immediate alarm or at the desired overflow alarm level. Additional sensors can be added for a wider area of leak detection. The system can be performance tested anytime. It is resettable via reset button on the receiver box.



203-488-2684 or 888-771-4929
 info@RelianceDetection.com
 www.RelianceDetection.com

RS-096-MK6 TECHNICAL SUBMITTAL DATA SHEET

ORDERING INFORMATION:

Valve Size	P/N	UPC
N/A	RS-096	857640005946

OPERATING SPECIFICATIONS:

Receiver Box

Transformer 120V AC
 Voltage 24V AC
 Absorbed Current 0.6 A
 Absorbed Power 15V A
 Frequency 50/60 Hz
 Working Temp. 0° to 100°F
 Audible Alarm 83 dB

Step-Down Transformer

Voltage 120, 208 or 240V AC to 24V AC

MATERIALS:

Receiver Box & Sensor

Body High-performance engineered polymer

CABLE LENGTHS:

Transformer Cable 12'
 Sensor Cable 8' (custom lengths avail.)

APPROVALS:

MA Board of Registration of Plumbers
 Approval – Code # P3-0818-66.

DIMENSIONS:

Receiver Box

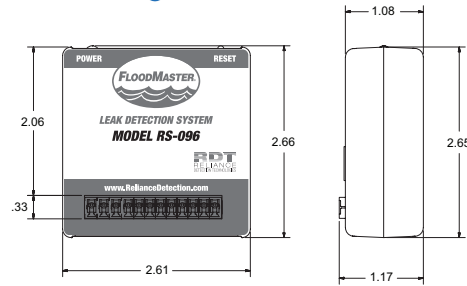

Water Sensor

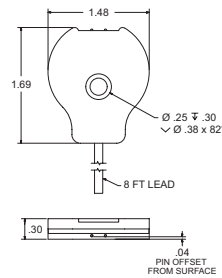

Metal Plate

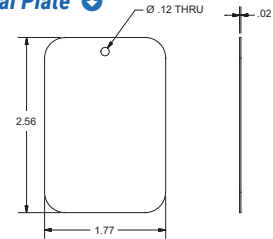

Step-Down Transformer

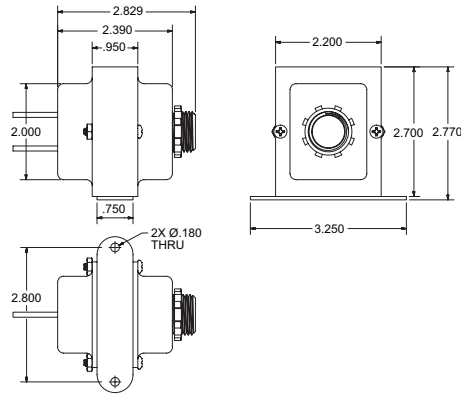

Mounting Plate

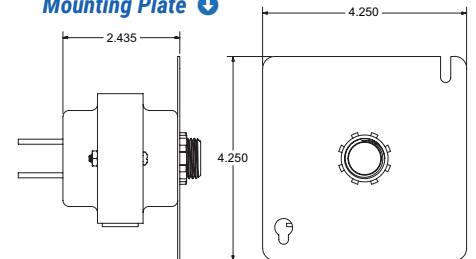

AVAILABLE ACCESSORIES:

- **Wired Water Sensors** – Additional sensors can be wired to a single receiver box for a wider range of leak detection, with 8', 25', 50' and 100' plenum-rated cable lengths available.

P/N RSA-101-008; -025; -050; -100

RDT recommends that installations be completed by a licensed plumber to ensure that all local code requirements are followed.



Reliance Detection Technologies, LLC
 27 Business Park Drive
 Branford, CT 06405

203-488-2684 or 888-771-4929
 info@RelianceDetection.com
www.RelianceDetection.com