



RS-095

- BY -

RDT
RELIANCE
DETECTION TECHNOLOGIES



Battery-Operated Water Leak Detection & Alarm System

Congratulations on your purchase of a FloodMaster RS-095 battery-powered plumbing leak detection and alarm from Reliance Detection Technologies. This product is designed to alert you with an audible alarm if a leak is detected.

To ensure proper installation and to maximize the performance of your RS-095 water leak detection system, please read this manual thoroughly before installing or operating the system.

NOTE: *This installation and operating manual contains important information about the operation of the RS-095 system. If this system is being installed for use by a different user, please be sure a copy of this manual is left with the system for future reference.*

www.RelianceDetection.com

Toll-Free: 888-771-4929

RS-095 System Components (included in kit):

- 1 – Alarm box with attached extendable water sensor (6' wire)
- 9V battery required (not included)

INSTALLATION INSTRUCTIONS

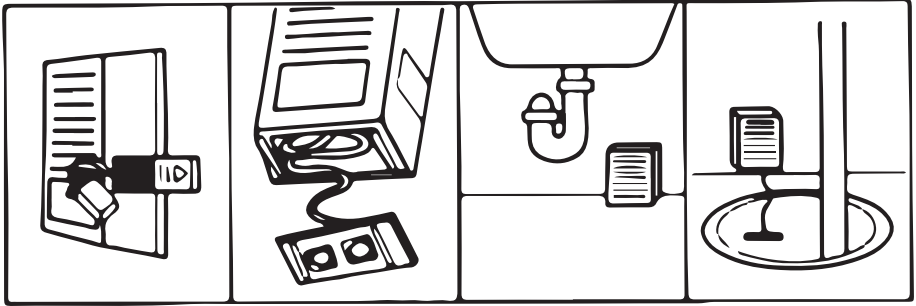

FIGURE 1

FIGURE 2

FIGURE 3

FIGURE 4

Battery Installation

1. Remove the cover on the battery compartment located on the right side of the alarm. (See Figure 1)
2. Extend the wires and snap a 9-volt battery onto the connector.
3. Place the battery back in the compartment.
4. Replace the cover.

Positioning the Sensor

1. The sensor is located on the bottom of the alarm. (See Figure 2) The alarm can be placed directly on the floor with the sensor compartment closed (See Figure 3), or the sensor compartment can be opened and the sensor wires extended to reach a sump pit or another remote location. (See Figure 4)
2. The alarm can be hung on a nail or screw in the wall with the sensor extended, and the sensor can be secured in place through the holes in the sensor panel.
3. Six feet of wire are attached to the sensor, but up to 100 ft. of speaker wire can be spliced into the line.

OPERATION & SYSTEM RESET

In the event the alarm activates, remove the sensor from the liquid and dry the metal contacts. Correct the problem causing the leak and place the sensor in the desired leak detection location once again as required.

MAINTENANCE

Replace the battery if the alarm has operated for an extended period of time, or if the battery expiration date is approaching. You may want to mark the battery expiration date on a piece of tape and attach it to the alarm when you install the battery. (Battery replacement once a year is recommended.)

RS-095

WATER

ALARM

1. Alarm box
2. Battery compartment
3. Sensor cable
4. Water sensor

Unit Dimensions:

4-1/8" High x

3" Wide x

1-1/2" Deep



Warning: For indoor use only.

NEED INSTALLATION OR SETUP ASSISTANCE?
Call toll-free: 888-771-4929
www.RelianceDetection.com/support/RS-095



203-488-2684 or 888-771-4929
info@RelianceDetection.com
www.RelianceDetection.com

27 Business Park Drive, Branford, CT 06405

All specifications subject to change without notice.

© Copyright 2020 Reliance Detection Technologies, LLC – A Madison Company
ECN # 11386, 09/2020, MF081, RevE